

TOPSTART ELECTRIC COOLANT ENGINE HEATER 0.5 - 4.0 KW

The TopStart is an electric coolant engine heater with an integrated pump for midsize engines.

BENEFITS

- Even distribution of heat to eliminate cold spots
- Reduces time to reach operating temperatures and full load acceptance
- Reduces engine wear
- Integrated pump and heater body

APPLICATIONS

- Gensets
- Large equipment



Direct link to website



Specifications

Heating Unit

- Die cast aluminum body
- PA66 electrical cover and supports base
- 150 cm power cable
- Heating element made of Incoloy 800

Circulating Pump

- Glandless circulation pump
- Flow rate: 1.6 to 2m³/h to 3m height manometer

Regulating Thermostat

- 0-80°C

Safety Thermostat

- Safety thermostat with manual reset rated 25A (110°C)

Available Power

- 0.5-4.0 kW
- 120, 208, 230, 240 V
- 50 or 60 Hz

TOPSTART 0.5-4.0 KW

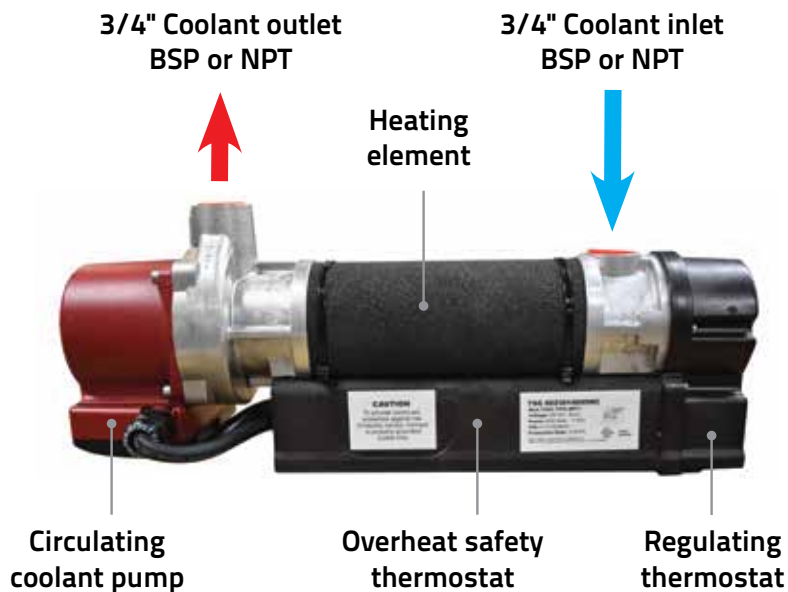
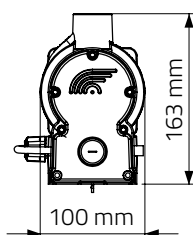
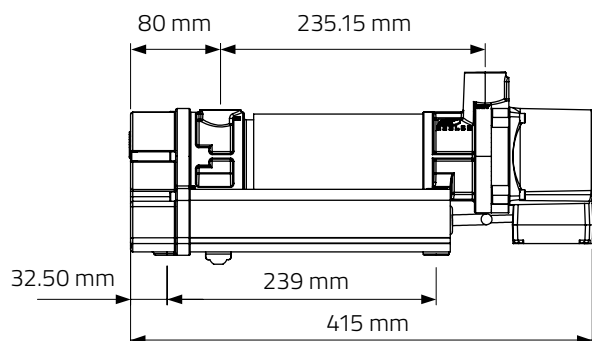

**DELIVERED WITH CONNECTION KIT
AND MOUNTING KIT**

CONNECTION KIT



3/4" BSP or NPT

INSTALLATION DIAGRAM

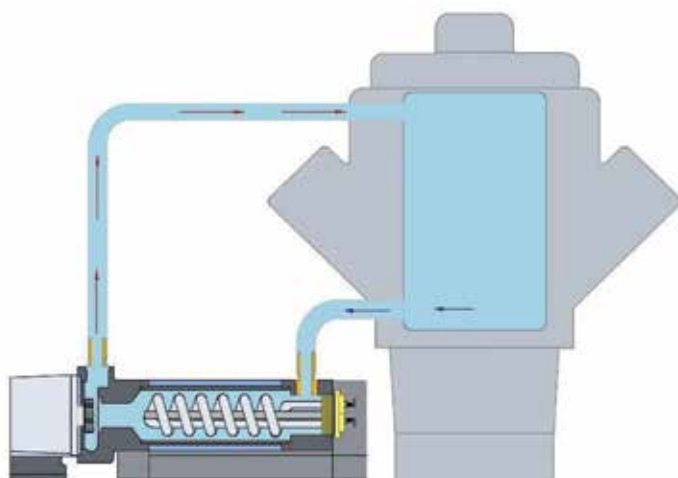

MOUNTING KIT



**MHS Motor Heiz Systeme
UG (haftungsbeschränkt)**

Binsheimer Straße 11
47495 Rheinberg
Tel. (+49) 02844 - 9009700
info@motorheizung.com

PHILLIPS & TEMPRO
industries®